

FUEL LEVEL SENSOR

High precision capacitive fuel level sensor with modular design. Basic version of Eurosens Dominator.

ХАРАКТЕРИСТИКИ:

| | |
|-------------------------------|--------------|
| Power supply | 9-32 V |
| Reverse polarity protection | Yes |
| Measurement error | ±1% |
| Ambient operating temperature | -40 - +85 °C |
| Output interfaces | RS-485 |
| Configuration interface | RS-485 |
| Ingress protection rating | IP 67 |

KEY FEATURES:

- ✓ Low cost.
- ✓ Compatible with GPS trackers over RS485 interface.
- ✓ LLS and Modbus protocols support.
- ✓ Bayonet coupling used by global OEMS
- ✓ Tank calibration tools save installation time.
- ✓ Remote and local monitoring of fuel consumption.



www.eurosenstelematics.com



+375 (1771) 33011



office@eurosenstelematics.com



Advantages of modular design

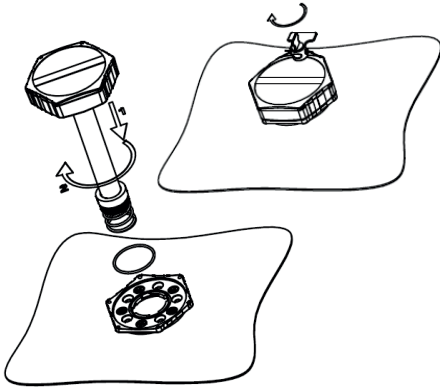

FAST BAYONET MOUNT TO THE TANK WITH AN EASY SENSOR SEALING

The sensor is not attached to the tank directly, but via an intermediate bayonet plate

Simplifies service work:

01

Easy sensor inspection

02

Easy water in the tank inspection

03

Easy cleaning procedure

Removing the bayonet and unscrewing the self-tapping screws from the tank is not required.

MODULAR ELECTRODES

The outer and inner electrode are connected to the electronic module by a threaded connection

- Easy transportation
- Lower stock investments
- Can buy electrodes separately
- Reduced costs when re-installing equipment to new machinery
- Easy diagnosis and cleaning

