



WIRELESS FUEL LEVEL SENSOR

Autonomous wireless fuel level and volume monitoring of vehicles, diesel gensets, fuel storages as a part of GPS tracking system or SCADA system. Wireless installation. The sensor contains a built-in long-life battery and an energy-saving Bluetooth transmitter.

SPECIFICATION:

Bluetooth version	4.2 BLE
Range of wireless connection	up to 200 m (in direct sight)
Transmitter mode	Customizable
Ambient operating temperature	-40 - +85 °C
Measurement error	±1%
Transmission power	+8dBm
Ingress protection rating	IP 67
Battery operating time	up to 7 years

KEY FEATURES:

- ✓ Autonomous sensor with long range wireless communication.
- ✓ Long-life battery.
- ✓ Tank calibration table can be stored in sensor.
- ✓ Modular design and mount with easy sealing.
- ✓ Projecting parts of the electrodes can be cut off if necessary.
- ✓ Dominator electrodes can be ordered separately or replaced.
- ✓ Small dimensions.

Advantages of modular design

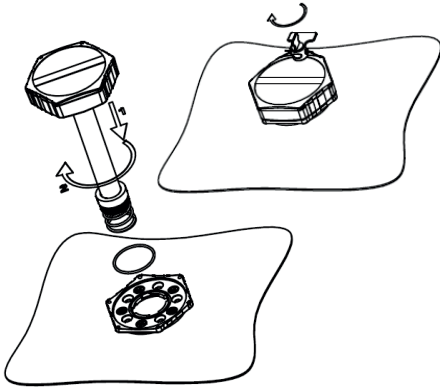

FAST BAYONET MOUNT TO THE TANK WITH AN EASY SENSOR SEALING

The sensor is not attached to the tank directly, but via an intermediate bayonet plate

Simplifies service work:

01

Easy sensor inspection

02

Easy water in the tank inspection

03

Easy cleaning procedure

Removing the bayonet and unscrewing the self-tapping screws from the tank is not required.

MODULAR ELECTRODES

The outer and inner electrode are connected to the electronic module by a threaded connection

- Easy transportation
- Lower stock investments
- Can buy electrodes separately
- Reduced costs when re-installing equipment to new machinery
- Easy diagnosis and cleaning

